

# PŘEKLAD

dne: 25 -11- 2016

PROVEDL/A  
JANA PROKEŠOVÁ

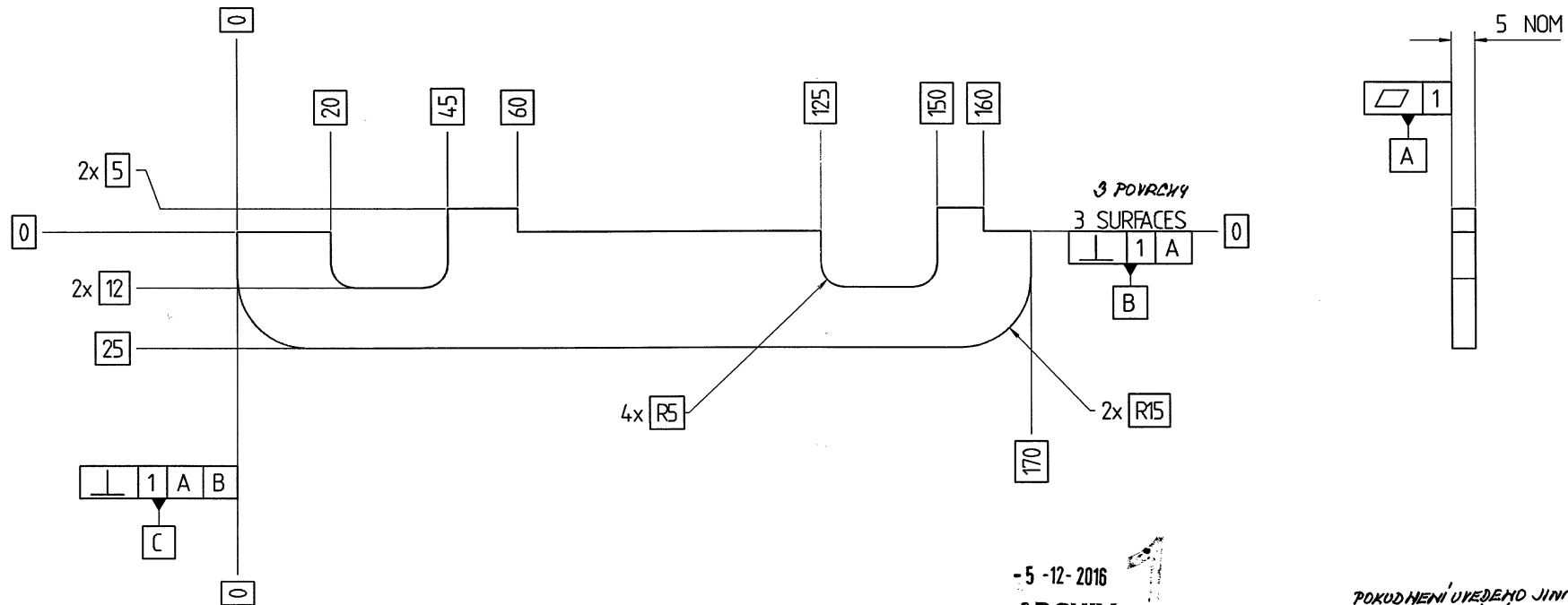

-5 -12- 2016

ARCHIV

YM/16/012404

POKUD NEJINÝ UVEDENO JINAK, VŠECHNY  
POVRCHY MUSÍ BÝT

UNLESS OTHERWISE SPECIFIED ALL

SURFACES TO BE 1 A B C

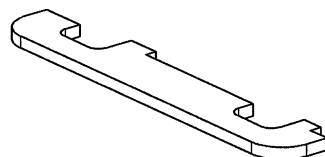

SNÍMAK  
PICTORIAL VIEW

STAV ZODPOVÍ:  
BEZ OTŘEPŮ  
BEZ NASTYNOTY

Condition at time of delivery	
de-scaled (degree of purity SA 2 1/2 acc. ISO 8501-1)	...
without burrs acc. WN 11310	X
Permissible top-end rounding during flame cutting (also positive bead acc. WN 10572)	...
oil-free / free of grease	X
oiled	...
oiling permissible	...
Indicate the required condition at time of delivery with an X.	

First angle projection	01	State was RFQ	STAV BYL RFQ	T81834		
General tolerance (GT) in mm						
Size range						
GT fine						
L 0,2 0,5 0,8 2 4						
≤ 30 ≤ 120 ≤ 400 ≤ 1000						
Lengths (L) and angle (L/Δ) = ± GT						
Tolerance Symbols ISO 1101						
○ roundness = 1/2a-Tol.						
□ straightness/flatness = GT						
⊙ concentricity/run out = GT						
≡ symmetry = GT						
// parallelism = GT						
⊕ position = GT						
Languages:						
EN						
Confidential document						
Refer to protection notice ISO 16016						
Repl.						
Orig.						
Released						
1434495/D2D/001/01						
A3						

wiring guide

14014012404

14014012404/01/01/01